

BURJ BINGHATTI  
JACOB & CO  
R E S I D E N C E S

# Project Facts

Project Name:

Burj Binghatti Jacob&Co Residences

Developer Name:

Binghatti Developer

Ownership:

Freehold

Location:

Dubai, Business Bay

Building Height:

Approx. 555m

Building Configuration:

6 B + G + 5 P + 98 Floors + Roof

Total Number of Units:

299 Units

Unit Type

Exclusive Villas

Sapphire Villa (2.5 Bedroom)

Emerald Villa (2 Bedroom)

Ruby Villa (3 Bedroom)

Exclusive Villas

Diamond Sky Mansion (4 Bedroom)

Fleur De Jardin Sky Mansion (6 Bedroom)

Sky Penthouses

Astronomia Sky Penthouse (5 Bedroom)

The Billionaire Sky Penthouse (7 Bedroom)





# Project Facts

## Composition of Units:

Emerald Villa: 70

Sapphire Villa: 70

Ruby Villa: 132

Diamond Sky Mansion: 12

Fleur De Jardin Sky Mansion: 12

Astronomia Sky Penthouse: 2

The Billionaire Sky Penthouse: 1

Floor Plate: 18,700 Sq. Ft.

Number of Units per Floor: 1 to 4 units

## Bedroom Types Sq. Ft.

Emerald Villa: 3,347 Sq. Ft.

Sapphire Villa: 3,351 Sq. Ft.

Ruby Villa: 3,314 Sq. Ft.

Diamond Sky Mansion: 7,032 Sq. Ft.

Fleur De Jardin Sky Mansion: 7,032 Sq. Ft.

Astronomia Sky Penthouse: 14,195 Sq. Ft.

The Billionaire Sky Penthouse: 27,800 Sq. Ft.

## Features & Amenities:

Gallery, Café Bar, Valet Parking, Outdoor Swimming Pool, Pool Bar, Gym, Games Room, Chef Table, Events Hall, Spa, Sky Gardens, Concierge Service.

Floor to Floor Height: 4.2m Total Height

Floor to Ceiling Height: Clear Height to be as per STR/MEP Design

Private Pools: 299 (All Units)

Sky Gardens: 4

GYM: 1

## Parking Bays for Each Unit:

2BHK: 2

2.5BHK: 2

3BHK: 2

Penthouse 6BHK: 4

Full Floor Penthouse 5BHK: 6

Duplex Penthouse 7BHK: 12

## Elevators:

Number of Residential Elevators: 12

Number of Private Elevators: 2

Number of Service Elevator: 2

Total Number: 16







# Stating Features

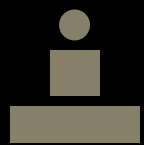

CONCIERGE  
SERVICE

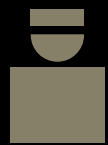

CHAUFFEUR  
SERVICE

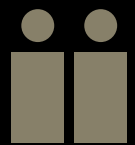

BODYGUARD  
SERVICE

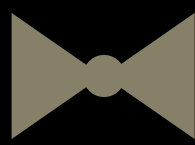

BUTLER  
SERVICE



TITANIUM  
ACCESS CARD

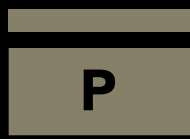

PARKING  
ACCESS CARD



LOBBY  
LOUNGE

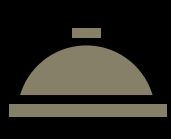

PRIVATE  
CHEF SERVICE

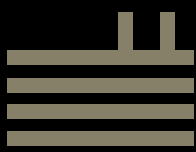

INFINITY  
POOL

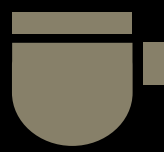

FOOD &  
BEVERAGE



SPA  
SERVICE

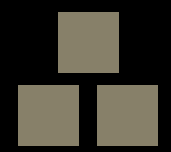

DAYCARE  
SERVICE

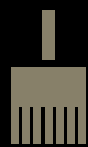

HOUSEKEEPING /  
CLEANING SERVICE

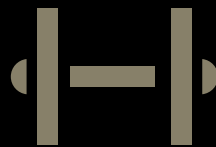

GYMNASIUM &  
TRAINING SERVICES



# About the project

The crown stands as the culmination of the Binghatti and Jacob & Co signature architectural and horological code, the emblem and purest representation of the brands. The crown is found at the highest altitude of the hypertower illuminating unrivaled opulence with its voluptuous and fascinating constructive display of the iconic and signature Jacob diamonds.





# Sapphire Villa

High-end dual bedroom suites on a quarter floor  
(with exclusive study and storage room)

The Sapphire Villa is an exceptional collection of two-bedroom luxury units that have been thoughtfully designed to meet every need. With spacious interiors that include a study/maid room and an additional storage area, the Sapphire Wing offers a truly premium living experience.

Within this exclusive collection, you'll find two-unit types, each offering a unique perspective on the magnificent cityscape of Dubai. The first unit type boasts a stunning side view of downtown Dubai and the iconic Burj Khalifa, while the second type treats you to the Creek Harbor and the Dubai Design District.

Number of Units

70

Minimum Price

USD 2.2M

Average Price

USD 2.6M

Maximum Price

USD 2.9M







# Emerald Villa

Exclusive two-bedroom residences on a quarter floor.

The Emerald Villa is an exquisite collection of two luxuriant bedroom units, each offering a unique perspective on the stunning cityscape of Dubai. Nestled within this premium collection, you'll find two-unit types, each boasting its own breathtaking views. The first unit type treats you to the awe inspiring sight of downtown Dubai and the iconic Burj Khalifa, while the second type provides a panoramic vista of the mesmerizing Dubai skyline and the waters of the Creek Harbor. With spacious interiors and luxurious amenities, Emerald Villa offers an unparalleled living experience in the heart of one of the world's most vibrant cities.

Number of Units

70

Minimum Price

USD 2.2M

Average Price

USD 2.7M

Maximum Price

USD 3.2M







# Ruby Villa

Deluxe quarter-floor three-bedroom residences.

The Ruby Villa is a truly exceptional collection of three-bedroom luxury units that offer an unrivaled living experience in the heart of Dubai. With spacious interiors and premium amenities, the Ruby Villa is designed to meet the needs of the most discerning individuals.

This exclusive collection comprises four unique unit types, each offering its own breathtaking views of the stunning cityscape. The first unit type provides a mesmerizing view of downtown Dubai and the iconic Burj Khalifa, while the second unit type offers panoramic vistas of the serene waters of the Creek Harbor and the vibrant Dubai Design District.

For those seeking a more varied perspective, the Ruby Villa also offers two additional unit types. The third unit type treats you to a stunning side view of downtown Dubai and the iconic Burj Khalifa, while the fourth unit type provides a perfect blend of the serene Creek Harbor and the vibrant Dubai Design District.

Number of Units

132

Minimum Price

USD 3.8M

Average Price

USD 4.2M

Maximum Price

USD 4.7M







# Diamond Sky Mansion

SKY mansion on half floor with 4 luxury bedrooms.

The Diamond Sky Mansion – a high-end residence named after the illustrious Diamond Wing watch by Jacob and Co. This opulent mansion offers a truly luxurious living experience in the heart of Dubai.

Boasting four spacious and exquisite bedrooms, the Diamond Sky Mansion occupies a full half-floor space spanning from levels 83 to 96, offering breathtaking 180-degree panoramic views of the city from every angle.

There are two types of sky mansions in this collection, each designed to cater to varied preferences. The first type treats you to an awe-inspiring view of the world-famous Burj Khalifa, while the second type offers a panoramic vista of the waters of the Creek Harbor and the vibrant Dubai skyline.

Luxurious amenities and exquisite attention to detail are the hallmarks of the Diamond Sky Mansion , making it the ultimate choice for those who demand the exceptional. From the finest materials and finishes, every aspect of this fascinating residence has been meticulously crafted to exceed your expectations.

Number of Units

12

Minimum Price

USD 8.4M

Average Price

USD 9.1M

Maximum Price

USD 9.8M







# Fleur DE Jardin Sky Mansion

SKY mansion on half floor with 6 luxury bedrooms.

The Fleur DE Jardin Sky Mansion - an exceptional residence named after the iconic Fleur DE Jardin watch by Jacob and Co. This magnificent mansion offers a truly luxurious living experience in the heart of Dubai.

Boasting six spacious and opulent bedrooms, the Fleur DE Jardin Sky Mansion occupies a full half-floor space spanning from levels 83 - 96, offering breathtaking 180- degree panoramic views of the city from every angle.

Within this premium collection, there are two types of sky mansions, each designed to cater to your unique preferences. The first type treats you to an awe-inspiring view of the world famous Burj Khalifa, while the second type offers a panoramic vista of the waters of the Creek Harbor and the vibrant Dubai skyline.

Luxurious amenities and exquisite attention to detail are the hallmarks of the Fleur DE Jardin Sky Mansion, making it the ultimate choice for those who demand the very best. From the finest materials and finishes, every aspect of this magnificent residence has been meticulously crafted to exceed your expectations.

Number of Units

12

Minimum Price

USD 8.4M

Average Price

USD 9.1M

Maximum Price

USD 9.8M







# Astronomia Sky Penthouse

An elite sky penthouse with five bedrooms on a private floor.

The Astronomia Sky Penthouse - an exclusive set of full-floor sky penthouse that offer an unparalleled living experience in Dubai. Named after the iconic and prestigious Astronomia watch by Jacob and Co., this collection boasts the finest in luxury living, with spacious and opulent interiors and breathtaking 360-degree views of the city.

Each sky penthouse in the Astronomia Collection features five luxurious bedrooms, ample living space, and the finest finishes and amenities. But it's the view that truly sets these residences apart, with a stunning panoramic vista of the entire cityscape. From the world-famous Burj Khalifa to the bustling downtown area, the serene waters of the Creek Harbour, and the vibrant Dubai Water Canal and Dubai Design District, you'll be able to take in the entire city from the comfort of your own home.

The Astronomia Sky Penthouse is the ultimate choice for those seeking the pinnacle of luxury living in Dubai. With its unrivaled location, opulent amenities, and breathtaking views, this exclusive collection offers an unparalleled living experience that is sure to take your breath away. Come and experience the finest that life has to offer in one of the most iconic and prestigious residences in the world.

Number of Units

2

Price

USD 48M



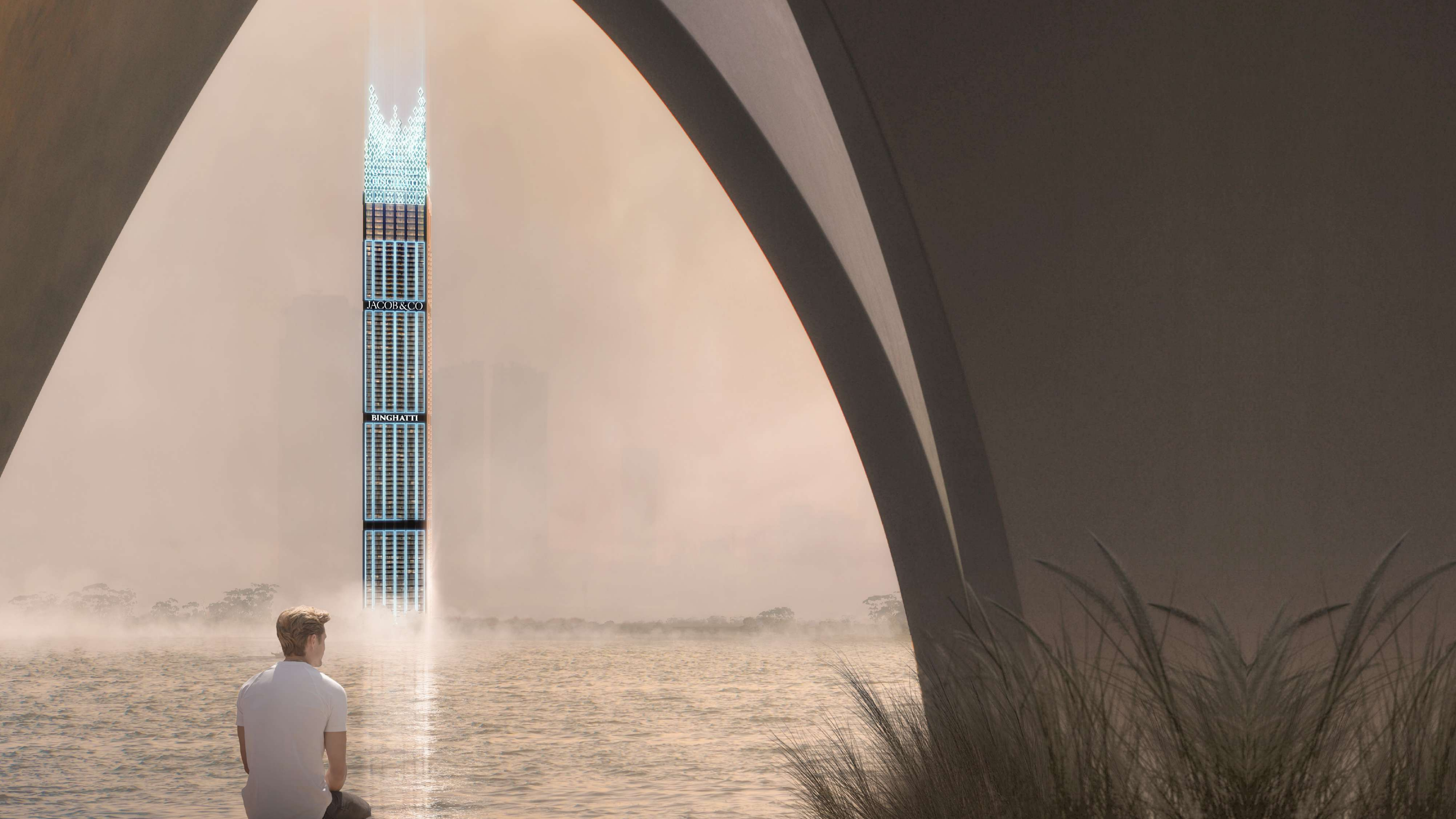

JACOB & CO

BINGHATTI







# Billionaire Sky Penthouse

An elite sky mansion with 7 Bedrooms on two private full floors at the top of the tallest Residential Tower in the world.

The Billionaire Sky Penthouse - a truly one-of-a-kind residence that embodies luxury and opulence at every turn. This magnificent penthouse is named after the iconic Billionaire watch by Jacob and Co. and is the epitome of exclusivity and sophistication.

Located at the top two floors of the Burj Binghatti Jacob and Co. Tower, the Billionaire Sky Penthouse boasts seven spacious and luxurious bedrooms, along with ample living space that is designed to cater to your every need. From the finest materials to the most unique lifestyle and design elements, the Billionaire Sky Mansion is the ultimate expression of luxury living.

Not only does the Billionaire Sky Penthouse offer the finest amenities and luxurious living space, it also boasts an unparalleled 360-degree view of the magnificent city of Dubai. From the iconic Burj Khalifa to the bustling downtown area, the vibrant Business Bay, and the tranquil waters of the Creek Harbor, the panoramic view from the Billionaire Sky Mansion Penthouse is simply breathtaking.

In addition to these iconic landmarks, you'll also enjoy a stunning view of the serene waters of the Dubai Water Canal and the vibrant Dubai Design District, all framed by the glittering skyline of Dubai. The Billionaire Sky Penthouse offers an unparalleled living experience, where every moment is one of pure luxury and indulgence.

Number of Units

1

Price

USD 205M







# Strategically Situated in Business Bay





# Materials



Velvet Fabric  
Dusky Blue



Velvet Fabric  
Royal Blue



Velvet Fabric  
Sapphire Blue

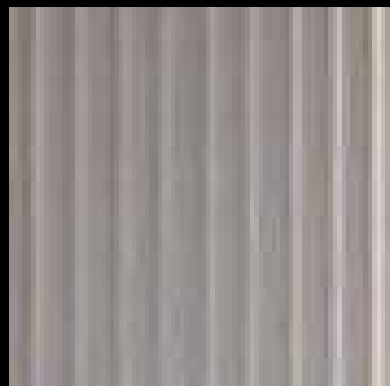

White Fluted  
Wood Panel



White Scalloped  
Flute Wood Panel



Tinted Brown  
Glass



Mirror  
Glass



Tinted Violet  
Glass

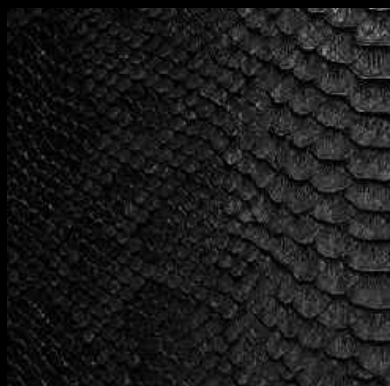

Leather Black  
Snake skin Texture

All finishes are subject to change without notice at our sole discretion for any reason including for aesthetic purposes.





# Materials



Nero Marquina  
Black Marble



Black River  
Marble



Asian St. Laurent  
Marble

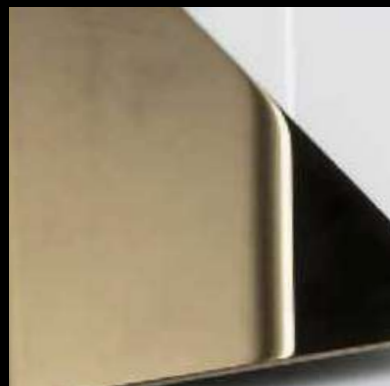

Brass Metal  
Glossy

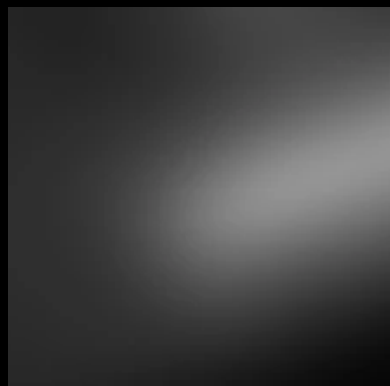

Glossy Black  
Panel



Calacatta Borghini  
Porcelain Slab-Polished

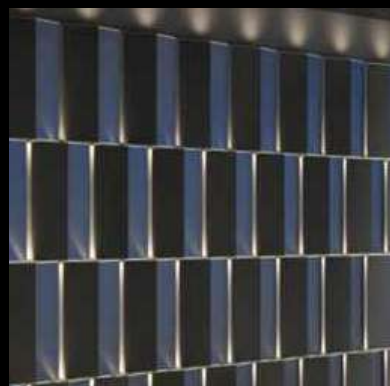

Stainless Matte  
Black Panel



Calacatta Borghini  
Marble

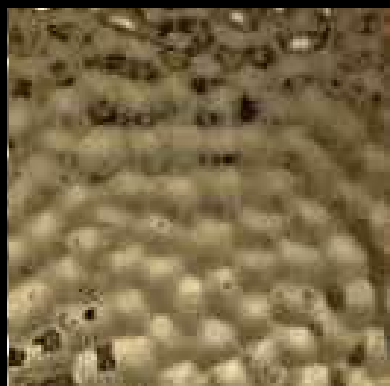

Brushed Stainless  
Steel Ripple Finish

All finishes are subject to change without notice at our sole discretion for any reason including for aesthetic purposes.

































**BINGHATTI | JACOB&CO**